

\* UNIT HEIGHT  
\* Modular Height = Unit Height (Without Make-up Piece)

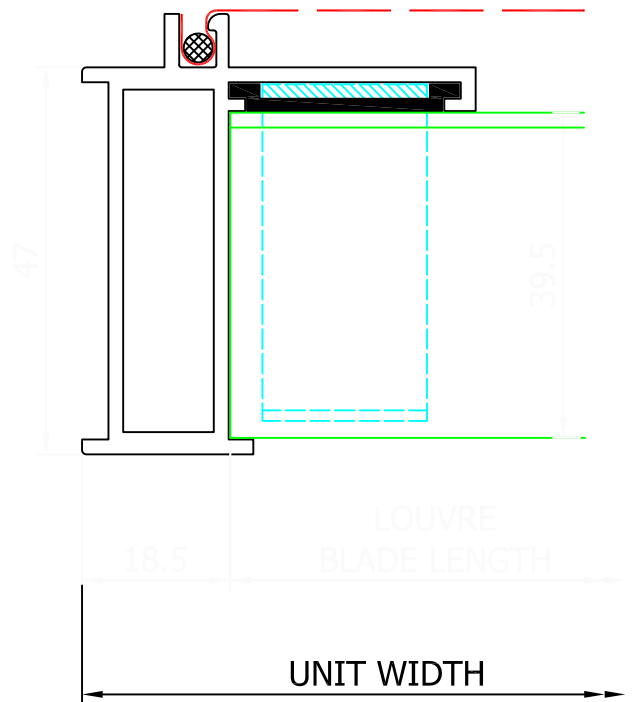
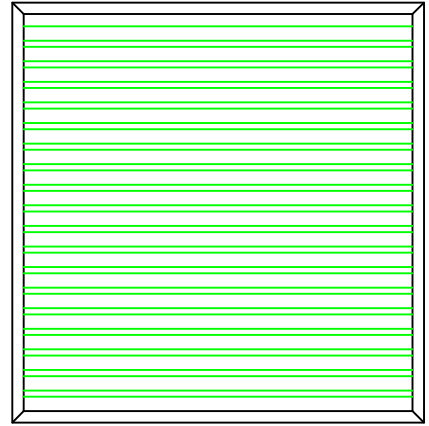

**DOORS SUITABLE FOR ELECTRICAL SUB-STATION**

**4 LEAF BI-FOLDING HINGED LOUVRE DOORS (TYPICAL DETAILS)**

- 2No. Pair Pad Handles (2 Sets)
- 1No. Slide Bolt with Hasp for Padlock
- 6No. Shoot Bolts
- 12No. Hinges (3 per Door Leaf)

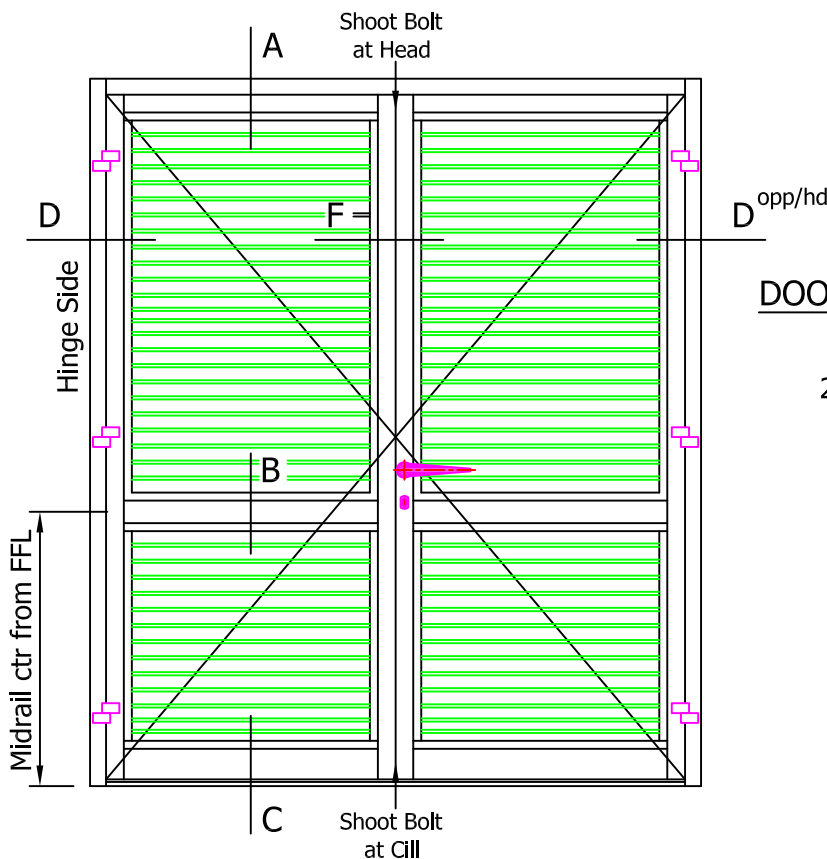
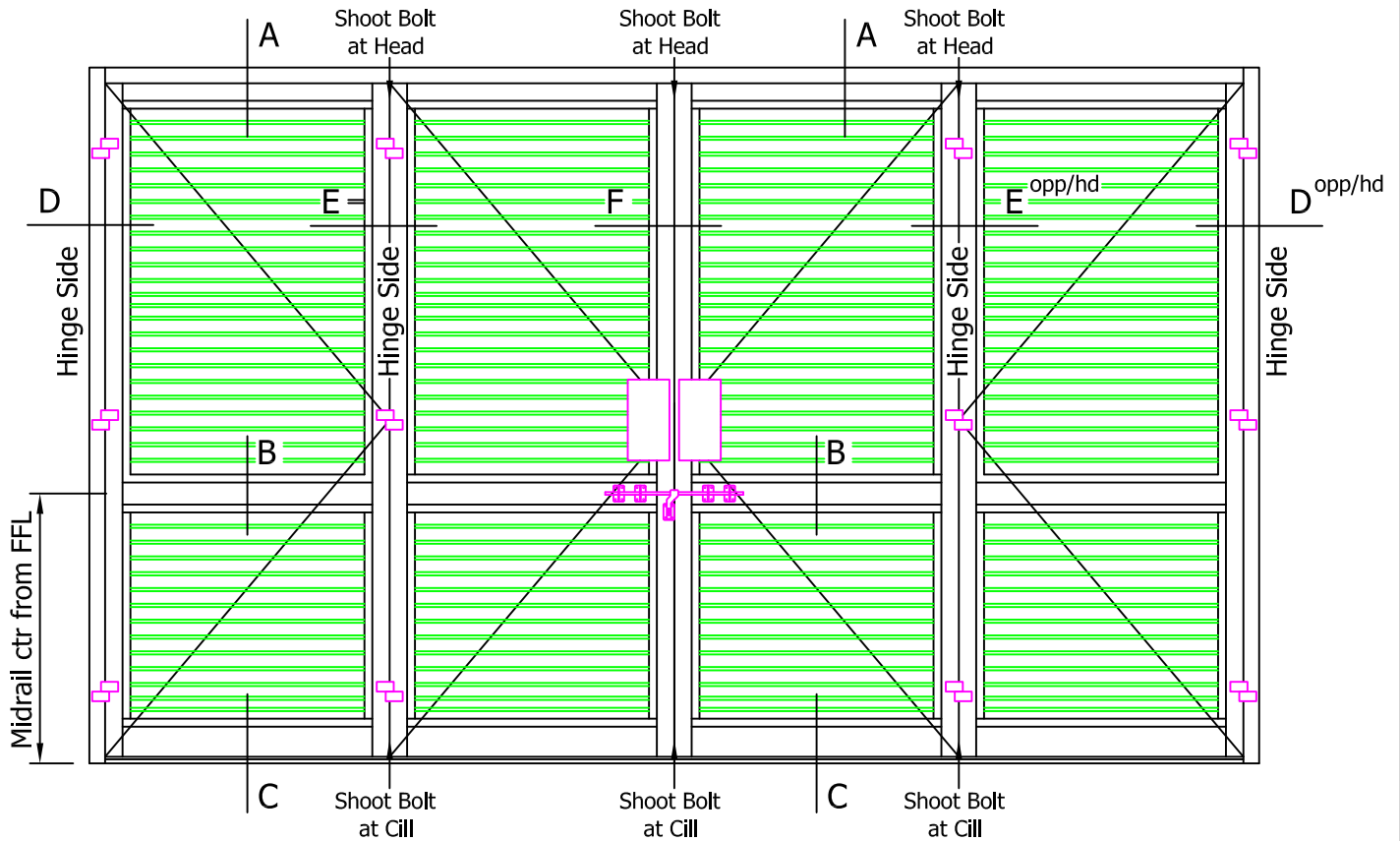

**DOORS SUITABLE FOR EQUIPMENT ROOM & BIN STORES**

**2 LEAF HINGED LOUVRE DOORS (TYPICAL DETAILS)**

- 1No. Pair Lever Handles (1 set) & Spindle
- 1No. Deadlock & Latch
- 2No. Escutcheon Plates
- 1No. Euro Cylinder
- 2No. Shoot Bolts
- 6No. Hinges (3 per Door Leaf)

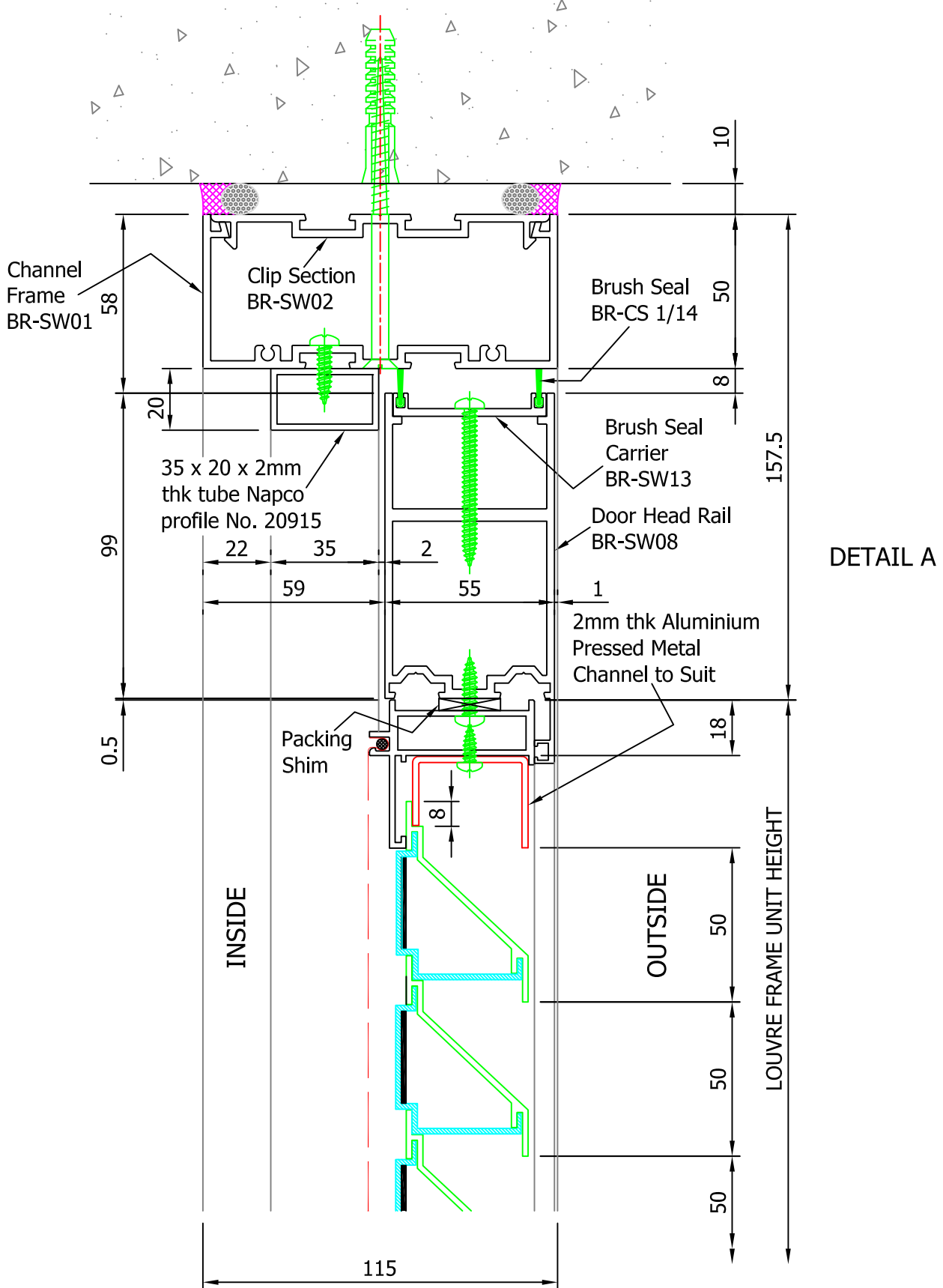

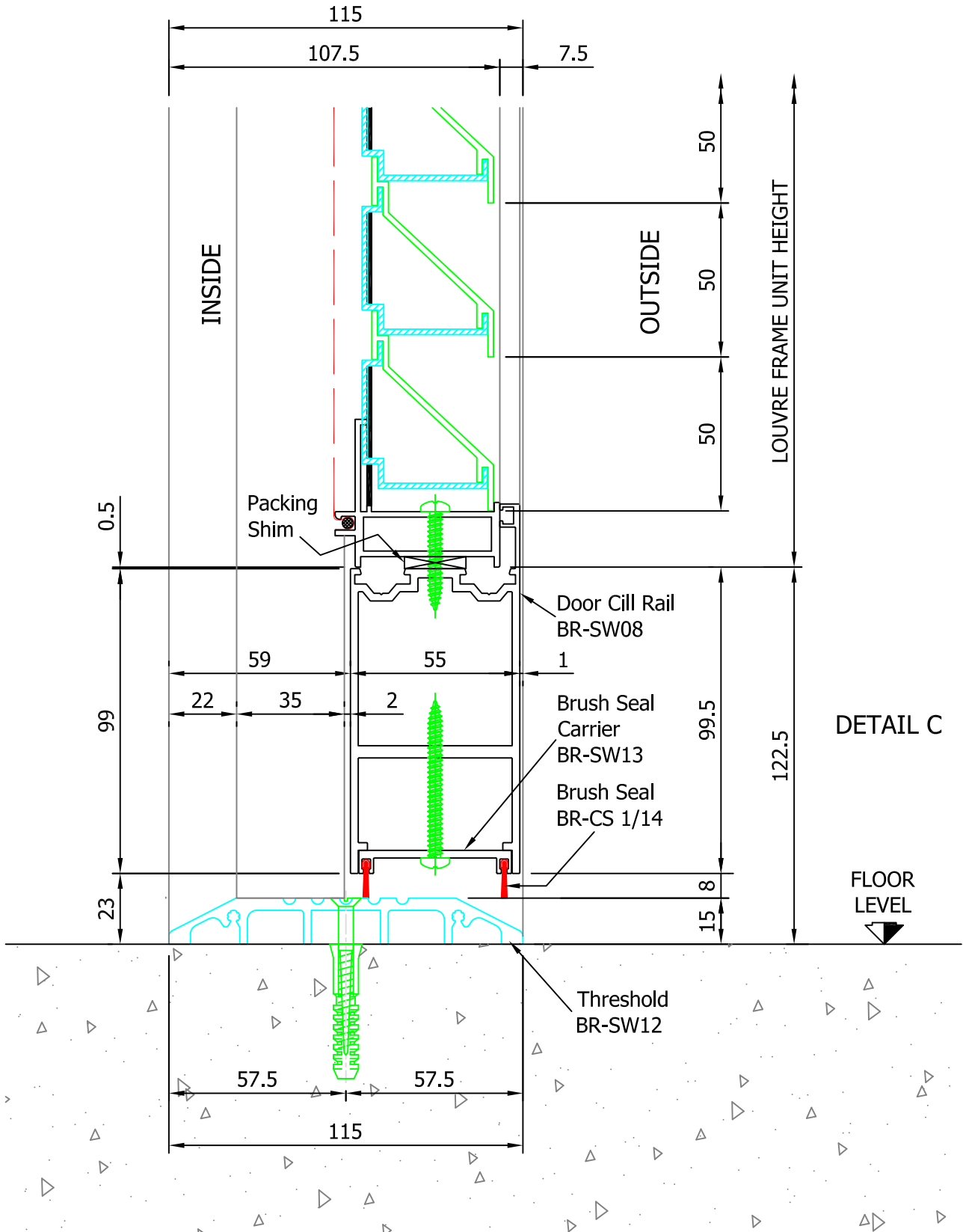

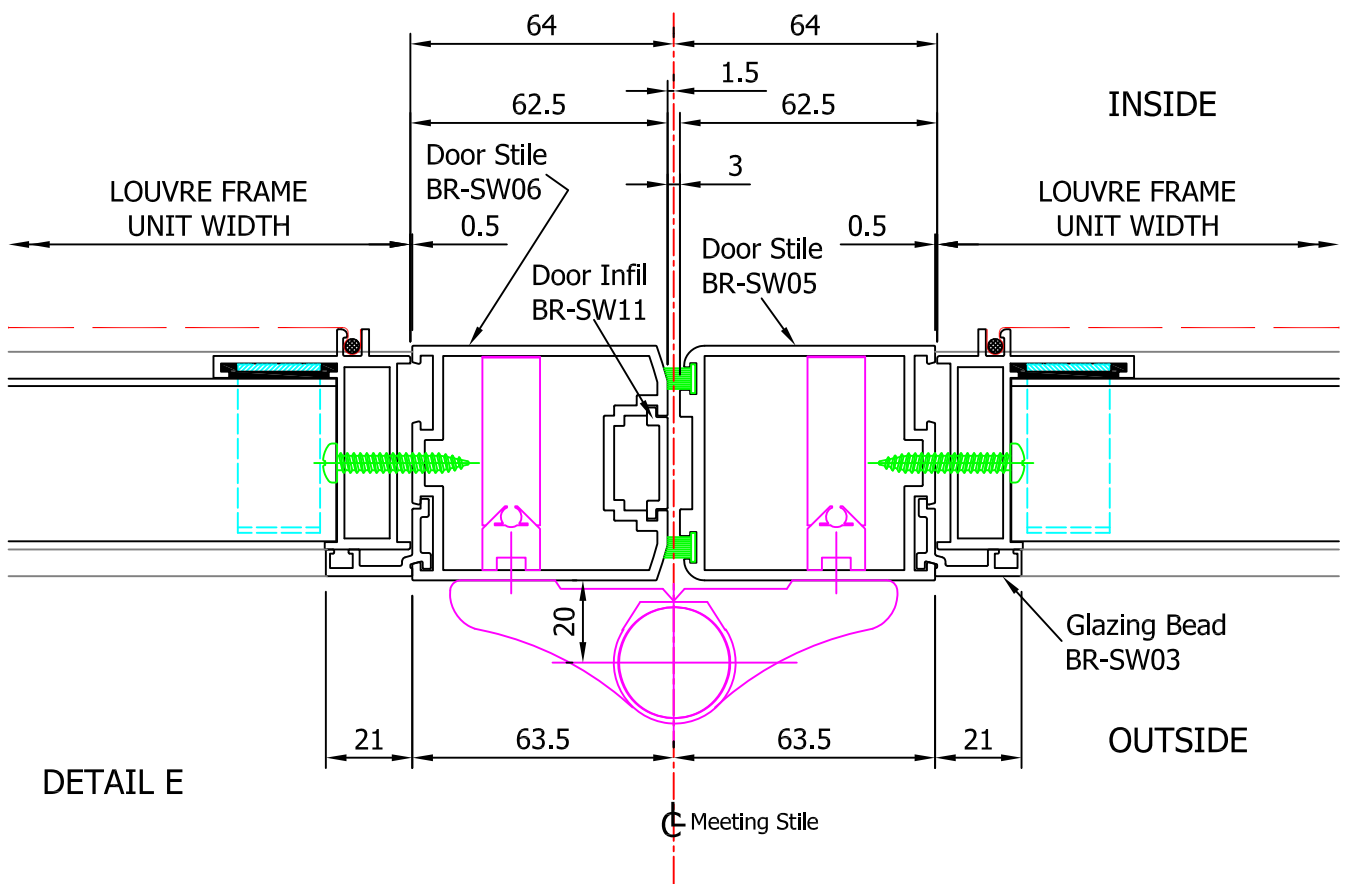
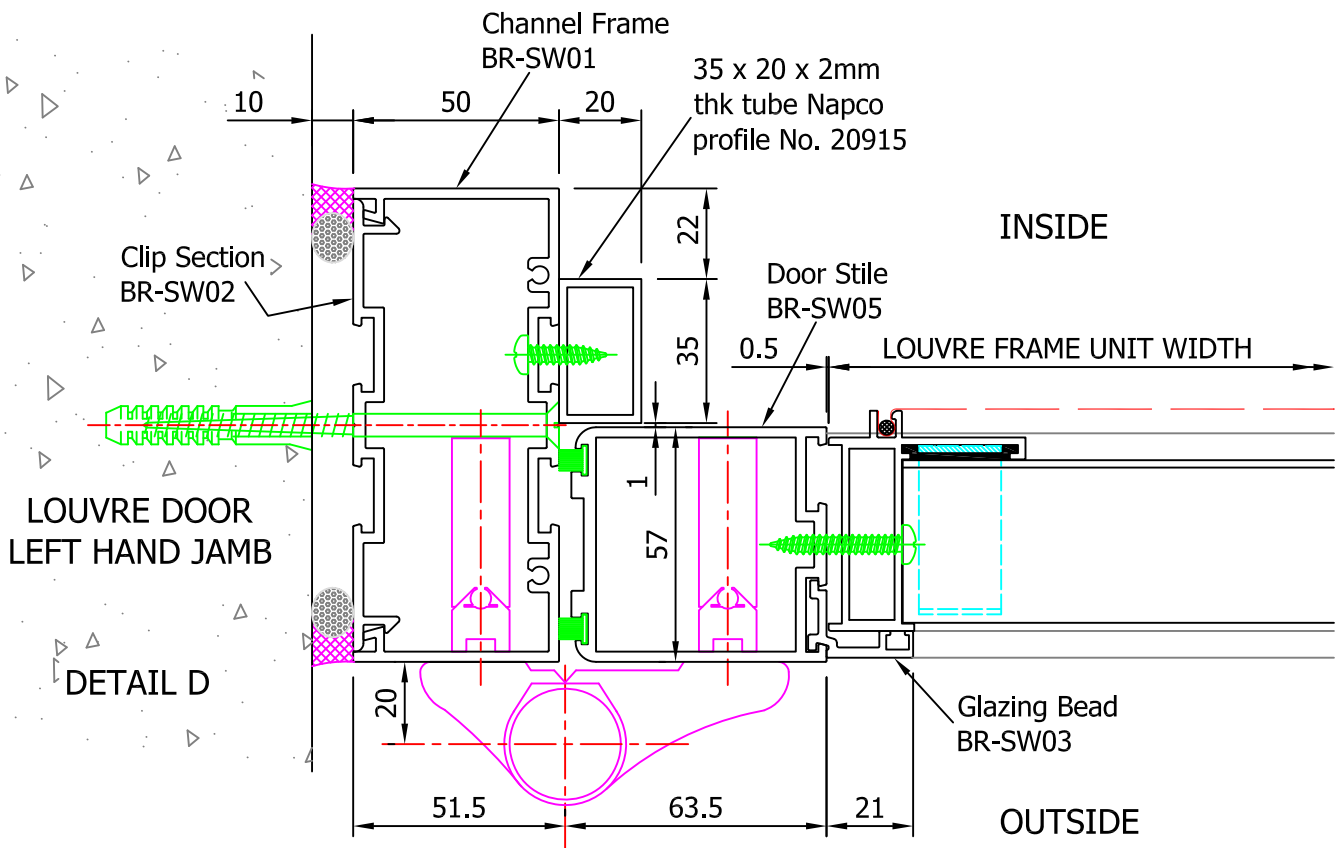

4 LEAF BI-FOLDING DOOR  
MEETING STILE HINGE DETAIL